

RIVA

66' RIBELLE







Riva 66' Ribelle



Riviera Ribelle





Riva 66' Ribelle





Riva 66' Ribelle







































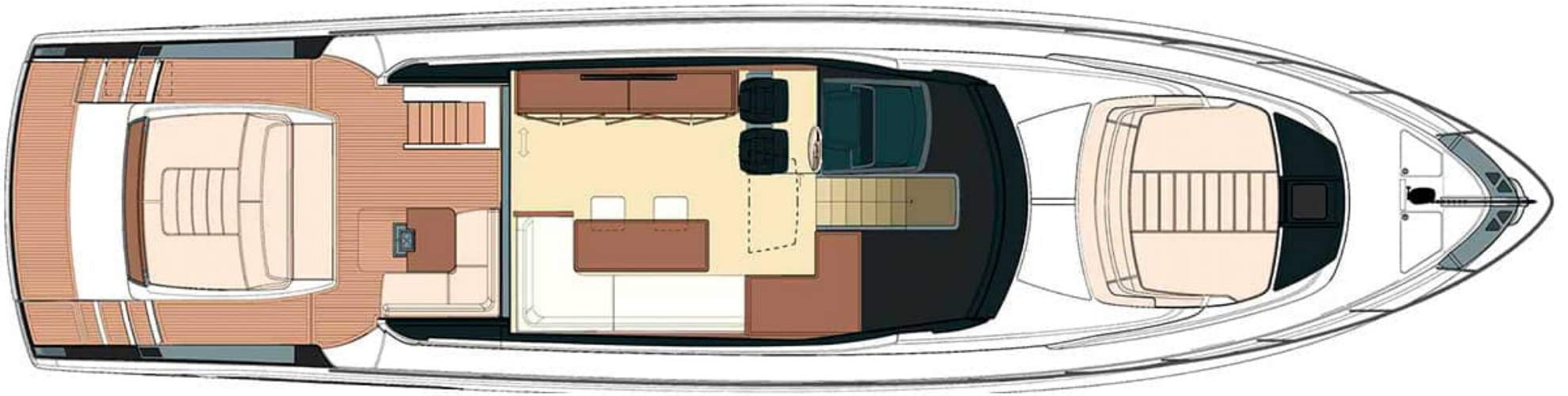



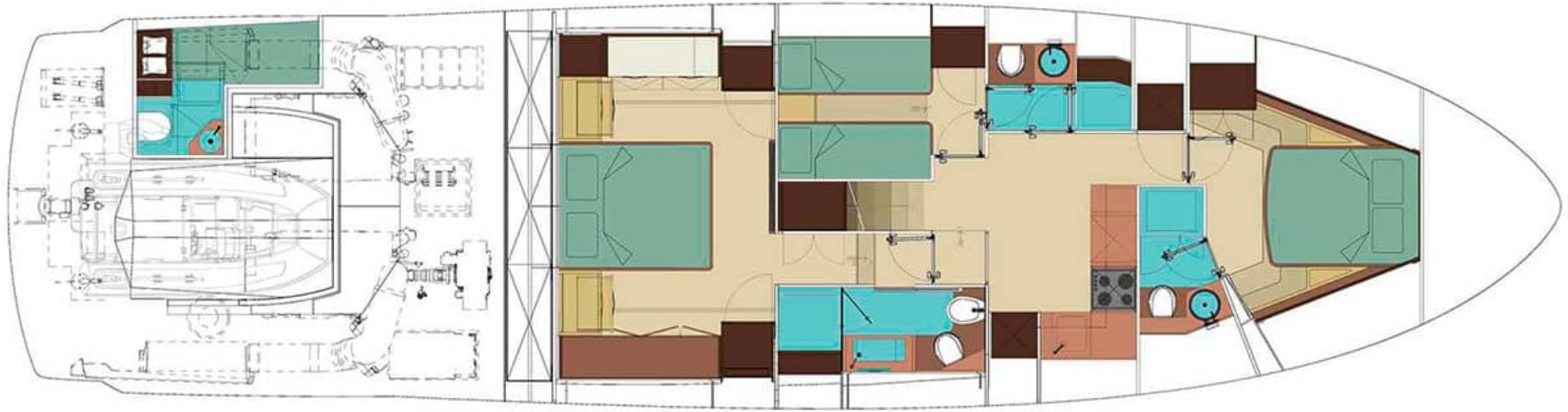

---

**Builder:** Riva

---

**Model:** 66' Ribelle

---

**Year build:** 2020

---

**Length overall:** 20.67 m

---

**Beam:** 5.29 m

---

**Flag:** Monaco

---

**Hull material:** GRP

---

**Engines:** 2 x MAN V12

---

**Engines power:** : 2 x 1.550 Hp

---

**Engine Hours :** 140

---

**Max Speed:** 69 kn

---

**Cruise Speed:** 61 kn

---

**Generators:** ONAN 1 x 19 kW

---

**Generators hours :** 600

---

**Fuel tank:** 3800 L

---

**Fresh water tank:** 710 L

---

**Price:** € 3.650.000

---

**VAT:** PAID

---



## OPTIONS LIST

---

### APPLIANCES

---

Oven combi in galley

---

Drawer fridge in cockpit

---

Ice maker in saloon

---

Washing / drying machine model WDU28540

---

### ENGINE ROOM EQUIPMENT

---

Water maker 130 lt/h

---

Generator battery charger

---

### THRUSTERS & STABILIZERS

---

Seakeeper stabilizer NG9

---

Stern thruster 15HP with proportional speed control

---

Proportional bow thruster

---

### NAVIGATION ELECTRONICS

---

Antenna Radar Simrad Broadband

---

Premium internet package (Coastal 4G and WiFi network)

---

Bridge additional monitor (16")

---

Simrad "Go-Free" navigation access point (navigation data displayed on Ipad/Smartphone)

---

Autopilot Simrad on main helm

---



---

AIS system

---

Flaps automatic management system

---

Chain counter pilot station

---

Chain counter on fly

---

### AUDIO VISUAL EQUIPMENT

---

Dinette : TV 49" with Apple TV

---

Master cabin : TV 49" with Apple TV

---

VIP cabin : TV 32", upgrade system Mini Hifi DVD with Apple TV

---

Guest cabin : TV 32", upgrade system Mini Hifi DVD with Apple TV

---

External Premium sound pack HQ

---

### COMPLEMENTS FOR THE EXTERIOR

---

Underwater lights on transom

---

Side underwater lights

---

Water plug in garage

---

Back seat on the pilot seat fly with cover

---

Pilot seat higher with foot rest bar

---

Teak on bow

---

Metallic version (Thetis colour, waterline standard, bright black details)

---

Manual Sunshade with carbon poles : cockpit, sundeck and bow areas

---

OPTIONS LIST

2 cleats on stern platform

Fiberglass top (bridge area) with electrical opening - metallic version

Teak deck grey caulking

Teak on fly grey caulking

Grey caulking for the teak in cockpit, gangway, aft platform and steps

Chain washing system

UltraMarine anchor diff. from STD

**COMPLEMENTS FOR THE INTERIOR**

Supertropic air conditioning

Master cabin electronic safe replacing storage compartment

Electric venetian blinds (except in galley, crew area and bathrooms)

Ambient lights

Extra plugs in galley, in various position



Gli elementi decorativi presenti nella brochure, come quadri, soprammobili, spugne ed arredo letto, sono stati messi a bordo per il solo servizio fotografico e non sono inclusi nella vendita.

The decorative items shown in the brochure, as artworks, ornaments, towels, linens and bed covers were on board for the photo shooting only and they are not part of the offer.